



ENID GRAND CHANDELIER INSTALLATION INSTRUCTIONS

These instructions are provided for your safety.

Please read carefully before commencing work and retain for future reference.

SAFETY INFORMATION

- * If you are in any doubt consult a person competent to give advice on the installation of electrical equipment.
- * This fitting should be fitted in accordance with IEE Wiring Regulations and the Building Regulations.
- * To prevent electrocution switch off at the mains supply before installing or maintaining this fitting. Ensure other persons cannot restore the electricity supply without your knowledge.
- * To avoid damage to concealed wiring during installation, establish the direction of the supply cable before drilling fixing holes.
- * This fitting is class 2 double insulated =  and should be fitted to a lighting supply protected by a 5 amp fuse or equivalent circuit breaker.
- * Always be sure to use the correct type and wattage of bulbs as indicated on the fitting. Never exceed the wattage stated.
- * When changing the bulb, always switch off at the mains and allow the old bulb to cool down before handling. Dispose of used bulbs carefully.
- * This fitting is designed for use with self-shielded tungsten halogen lamps = 

INSTALLATION

1. Ensure the house electricity supply is off at the fuse board.
2. Do not remove the packaging surrounding the crystal droppers or any frame transportation ties on the lower part of the fitting until the chandelier has been installed.
3. Before removing the existing rose, carefully note the position of each set of cables. If there are loop in cables that are not connected to the light these must be terminated in a separate terminal block not connected to the fitting.
4. Remove mounting bracket from fitting by undoing retaining screws. Using the bracket as a template, mark and then drill the fixing holes in the ceiling. Ensure that the holes are drilled into a joist or other suitable mounting and not just the plaster
5. Fix the mounting bracket to ceiling using suitable fixings. ① **Take care not to damage wiring.**
6. Screw the central stem of the chandelier into the central hub on the lower half of the fitting ② Once the stem has been fully tightened, lock the stem in place by tightening the small grub screw located on the receiving collar using the hex key provided.
7. Chain links may be adjusted to reduce the height of the fitting. Using two pairs of pliers, carefully open the chain links and remove the required number to achieve the desired fitting height. Note: A cloth should be used between the jaws of the pliers to protect the decorative finish. Pull any excess cable through the ceiling cup. Attach the bottom adjustable chain link to the last link of the support chain and to the connection ring of the chandelier. The link is opened by twisting the barrel nut at the side anti-clockwise, hooking the chain link over the top ring of the chandelier and retightening to close the link. **IMPORTANT** ensure the chain is supporting the weight of the fitting and not the electrical cable.
8. Carefully remove the protective packaging surrounding the vertical crystal beaded swags. Attach the metal hooks at the lower ends of the swags to the opposite fixing points to the upper ring on the lower part of the frame. ③
9. Use a screwdriver to lever open the connector block housing and feed supply cable through the rubber sleeve. Whilst supporting the weight of the fitting, make electrical connections as follows: ④
 - Connect the supply live (normally brown or red) to fitting live (marked “L”) on the terminal block.
 - Connect the supply neutral (normally blue or black) to fitting neutral (marked “N”) on the terminal block.

Ensure electrical connections are tight and no loose strands of wire are left out of the connector block.

This fitting is double insulated and no earth should be connected to any part of this fitting. If there are earth wires present please terminate these into a separate terminal block (not supplied) to ensure continuity for the house earth circuit is maintained. Wrap the earth terminal block in 2 layers of good quality insulation tape and make sure the terminal block is kept away from the fitting.

10. Attach the fitting to the mounting bracket using the retaining screws removed earlier. Take care not to trap wires in the process. ⑤
11. Carefully remove any transportation ties linking the lower chandelier tiers together and remove the remaining protective packaging surrounding the lower crystal droppers allowing the chandelier to take shape.

Laura Ashley

IL3998

12. Fit the bulbs type and wattage as shown on fitting. **The wattage indicated must not be exceeded.** © If using tungsten halogen lamps these must be a self-shielded type marked  Do not touch halogen bulbs with bare hands as this will shorten their life.
13. Switch on the electricity supply at the fuse board.

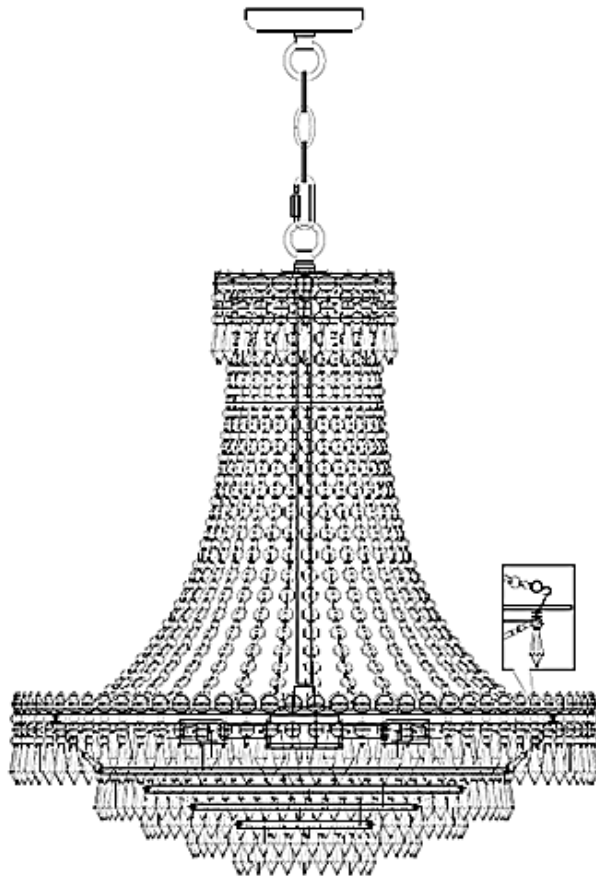
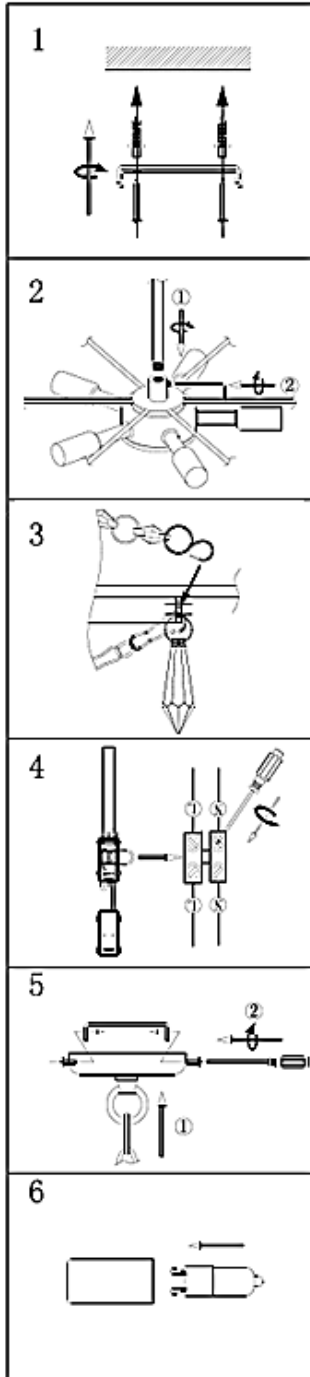

GENERAL INFORMATION

This fitting is designed for internal use only and must be fitted to a DRY SURFACE as any dampness in plaster or paint can damage the finish. **Do not use polish or abrasive cleaner - just a soft dry cloth.**