

ISAAC WALL LAMP INSTALLATION INSTRUCTIONS

These instructions are provided for your safety.

Please read them carefully before commencing work and retain them for future reference.

SAFETY INFORMATION

- * If you are in any doubt consult a person competent to give advice on the installation of electrical equipment.
- * This fitting should be fitted in accordance with IEE Wiring Regulations and the Building Regulations
- * To prevent electrocution switch off at the mains supply before installing or maintaining this fitting. Ensure other persons cannot restore the electricity supply without your knowledge.
- * To avoid damage to concealed wiring during installation, establish the direction of the supply cable before drilling fixing holes.
- * This fitting is Class 2 double insulated =  and should be fitted to a lighting supply protected by a 5 amp fuse or equivalent circuit breaker.
- * Always be sure to use the correct type and wattage of bulbs as indicated on the fitting. Never exceed the wattage stated.
- * When changing the bulb, always switch off at the mains and allow the old bulb to cool down before handling. Dispose of used bulbs carefully.

INSTALLATION

1. Ensure the house electricity supply is off at the fuse board.
2. If you are fitting this unit in place of an existing fitting, you may find that there are more than 3 sets of cables connected within the wall cup. Before removing the existing wall cup, carefully note the position of each set of cables. If there are loop in cables that are not connected to the light these must be terminated in a separate terminal block not connected to the fitting.
3. Remove the mounting bracket from the fitting by undoing the screws located in the side of the cup and retain for later.
4. Attach the mounting bracket to the wall using suitable fixings. Ensure the screws are firmly fixed into a solid or other suitable mounting and not just the plasterboard.
5. Weight of the fitting must be supported whilst you make the electrical connections as follows:
Connect the supply live (normally brown or red) to fitting live (marked "L") on the terminal block.
Connect the supply neutral (normally blue or black) to fitting neutral (marked "N") on the terminal block.
Ensure electrical connections are tight and no loose strands of wire are left out of the connector block.
This fitting is double insulated and no earth should be connected to any part of this fitting. If there are earth wires present please terminate these into a separate terminal block (not supplied) to ensure continuity for the house earth circuit is maintained. Wrap the earth terminal block in 2 layers of good quality insulation tape and make sure the terminal block is kept away from the fitting.
NOTE: Ensure electrical connections are tight and no loose strands of wire are left out of the terminal block.
6. Move any excess cable into wall void as you may experience difficulty fitting excess cables into wall light cup.
7. Offer the fitting to the mounting bracket and secure in place using the screws removed earlier. **Take care not to damage wiring.**
8. Fit the bulb, type and wattage as indicated on the fitting. **The wattage indicated must not be exceeded.**
9. Switch on the electricity supply at the fuse board.

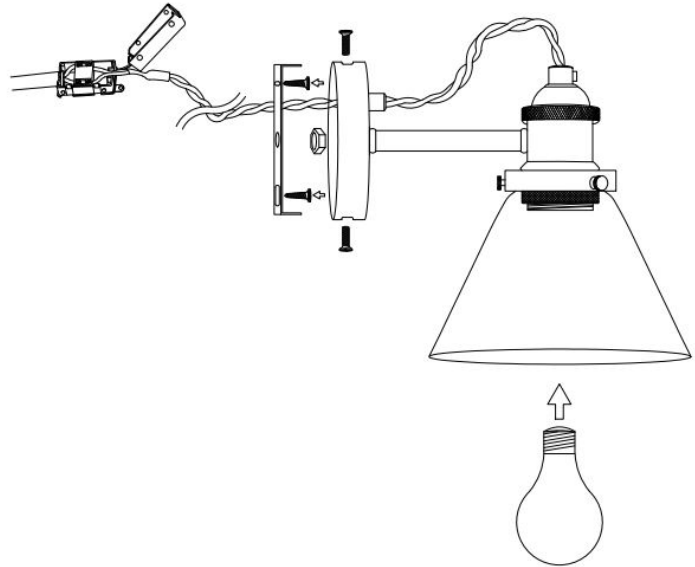

GENERAL INFORMATION

This fitting is designed for internal use only and must be fitted to a DRY SURFACE as any dampness in plaster or paint can damage the finish. **Do not use polish or abrasive cleaner - just a soft dry cloth.**