

## LED MOTHER AND CHILD FLOOR LAMP

These instructions are provided for your safety.  
Please read carefully before commencing work and retain for future reference.

### SAFETY INFORMATION

- \* If the flexible cable of this product is damaged it should be exclusively replaced by the manufacturer or a similar qualified person to avoid a hazard.
- \* To prevent electrocution switch off at the mains supply before assembling or maintaining this floor lamp. Ensure the plug is not connected to any power supply and read instruction before assembly.
- \* This floor lamp is supplied with plug-in electronic driver and is suitable for 240 Volt ring mains.
- \* We would recommend when not in use to switch off or unplug LED electronic driver from the wall socket.



THIS PRODUCT CONTAINS A LIGHT SOURCE(S) OF ENERGY EFFICIENCY CLASS

### ASSEMBLY INSTRUCTIONS

1. Unpack floor lamp and remove all packaging material. Be careful that you do not scratch surface of the stems whilst removing wrapping.
2. Where required remove plastic / cardboard cable protectors that are fitted at cable entry points inside stems and floor lamp base.
3. Screw the stem into the main body of the floor lamp. ①
4. Ensure cable passes floor lamp base then screw the base onto the assembled stem. ②
5. Stand the floor lamp upright then make sure the assembled parts are sufficiently tightened. ③
6. Unpack the electronic plug-in driver module and plug the connector into the cable protruding from the floor lamp then lock these together by rotating outer ring. ④
7. Plug the electronic driver into the mains supply socket.
8. Your floor lamp is now ready for use.

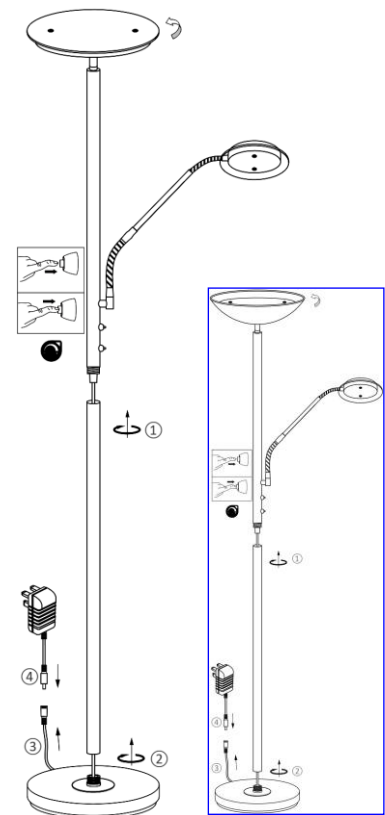

### HOW TO USE

- Top switch - push button operates LED UP lighter.
- Lower switch - push button operates LED READING light.
- Press and release button to turn ON or OFF LED light.
- When LED lamp is ON press push button switch to change light intensity UP / DOWN and release button when required light intensity is reached. (If you want the light intensity steps reversed, release the button then press again).
- This lamp has a memory function, LED lamp will illuminate at the same light intensity it was when it was turned OFF using the push button switch.

**LED uplighter & LED Goose neck reading light tilt and swivel.**

|                         |                         |
|-------------------------|-------------------------|
| Adaptor Input Voltage:  | 220-240 V~, 50/60 Hz    |
| Lamp Input Voltage:     | 24 VDC / 1,3 A Class II |
| Bulb Type:              | LED                     |
| Power:                  | 29 W (LED, 20 W + 5 W)  |
| Protection Class (Lamp) | Class III               |

### GENERAL INFORMATION

This floor lamp is designed for internal use only.  
**Do not use polish or an abrasive cleaner - just a soft dry cloth.**

To register your product for an extended five-year warranty, please complete the simple form at

[www.darlighting.co.uk/warranty](http://www.darlighting.co.uk/warranty)

You'll need to fill in the details of the product, the retailer you purchased it from, and also the installer and the installation. Please also upload a clear copy of the original purchase invoice or receipt to complete this registration.

**UK:** där Lighting Ltd, Wildmere Road, Banbury, Oxon, OX16 3JZ

**Ireland & EU:** Dar Lighting Ireland Limited, Suite 108, Q House, 76 Furze Road, Sandyford Industrial Estate, Dublin 18