

WILLOW 4LT PENDANT INSTALLATION INSTRUCTIONS

These instructions are provided for your safety.

Please read carefully before commencing work and retain for future reference.

SAFETY INFORMATION

- * If you are in any doubt consult a person competent to give advice on the installation of electrical equipment.
- * This fitting should be fitted in accordance with IEE Wiring Regulations and the Building Regulations.
- * To prevent electrocution switch off at the mains supply before installing or maintaining this fitting. Ensure other persons cannot restore the electricity supply without your knowledge.
- * To avoid damage to concealed wiring during installation, establish the direction of the supply cable before drilling fixing holes.
- * This fitting is Class 1 = $\frac{1}{\text{I}}$ and should be fitted to a lighting supply (with earth) protected by a 5 amp fuse or equivalent circuit breaker.
- * Always be sure to use the correct type and wattage of bulbs as indicated on the fitting. Never exceed the wattage stated.
- * When changing the bulb, always switch off at the mains and allow the old bulb to cool down before handling. Dispose of used bulbs carefully.
- * This product should be positioned and installed away from direct sunlight.

INSTALLATION

1. Ensure the house electricity supply is off at the fuse board.
2. Before removing the existing fitting, carefully note the position of each set of cables. If there are loop in cables that are not connected to the light these must be terminated in a separate terminal block not connected to the fitting.
3. Remove mounting bracket from fitting by removing the two screws located on either side of the ceiling cup. Using the bracket as a template, mark and then drill the fixing holes in the ceiling. Ensure that the holes are drilled into a joist or other suitable mounting and not just the plaster.
4. Chain links may be adjusted to reduce the height of the fitting. Using two pairs of pliers, carefully open the chain links and remove the required number to achieve the desired fitting height. Note: A cloth should be used between the jaws of the pliers to protect the decorative finish. Pull any excess cable through the ceiling cup.
5. **IMPORTANT** ensure the chain is supporting the weight of the fitting and not the electrical cable.
6. Fix the mounting bracket to ceiling using suitable fixings. **Take care not to damage wiring** ①
7. **The weight of the fitting must be supported whilst making the electrical connections as follows:** ②
 - Connect supply live (normally brown or red) to fitting live (marked “L”) on the terminal block.
 - Connect supply neutral (normally blue or black) to fitting neutral (marked “N”) on the terminal block.
 - Connect supply earth (normally green/yellow or unsheathed) to earth (marked “ $\frac{1}{\text{I}}$ ”) on terminal block.Ensure electrical connections are tight and no loose strands of wire are left out of the terminal block. Ensure terminals and rubber sleeve is correctly seated then close connector block housing by snapping together.
8. Attach the fitting to the mounting bracket using the retaining screws removed earlier. **Take care not to trap wires in the process** ③
9. **Fit the bulb:** Type and wattage as indicated on the fitting. **The wattage indicated must not be exceeded.**
10. Attach the lower branch layers: Place the centre hole in the larger, upper layer (1) over the central stem. Whilst holding this in place, fit the lower branch section (2) over the stem and rotate clockwise to secure the parts in place. If cross-threading occurs, carefully undo and start again.
11. Fitting the crystal droppers (3) Carefully remove the protective wrapping surrounding the droppers. Gently pass the metal retaining clip located at the top of each dropper through the holes at the ends of the metal branch-arms to fix in place ④
12. Switch on the electricity supply at the fuse board.

LAURA ASHLEY

IL4687

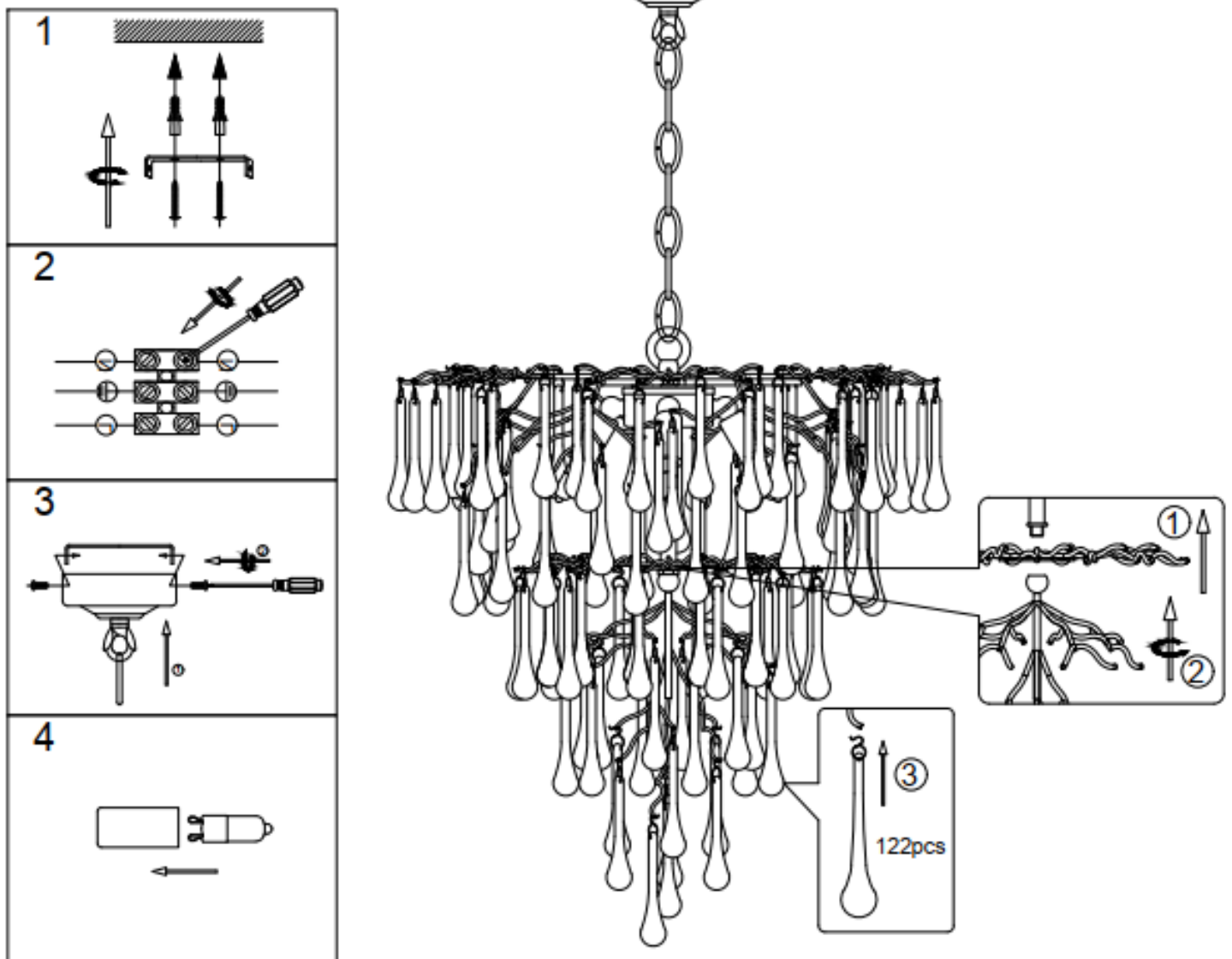

GENERAL INFORMATION

This fitting is designed for internal use only and must be fitted to a DRY SURFACE as any dampness in plaster or paint can damage the finish. **Do not use polish or abrasive cleaner - just a soft dry cloth.**