

ENGLISH  
HERITAGE

IL4700

# ELTHAM

## SWAG GLASS TABLE LAMP

These instructions are provided for your safety.

Please read carefully before commencing work and retain for future reference.

### SAFETY INFORMATION

- \* If you are in any doubt consult a person competent to give advice on the assembly of electrical equipment.
- \* The supply cable runs through the inside of the floor stand, take care not to place undue stress on the cable whilst unpacking to prevent the possibility of a poor connection.
- \* Always be sure to use the correct type and wattage of bulbs as indicated on the product.
- \* If the external flexible cable of the lamp is damaged it shall be exclusively replaced by the manufacturer or his service agent or a similar qualified person in order to avoid a hazard.
- \* When changing the bulb, always unplug at the mains and allow the old bulb to cool down before handling. Dispose of used bulbs carefully.

### ASSEMBLY INSTRUCTIONS

1. Unpack the product and remove all packaging. Be careful not to scratch the surface of the product whilst removing the plastic wrapping.
2. Attach glass swags as shown in the diagram opposite whilst taking care glasses do not collide and chip. ① Bend the small clasp at right angle then fit this through the holes in the metal frame and bend clasp at right angle again to secure into position.
3. Fit bulb: type and wattage as indicated on table lamp. ② **The wattage indicated must not be exceeded.**
4. Remove the finial from the top of the stem then fit shade and secure into position using the finial. ③ **Do not over tighten finial.**
5. Table lamp is now ready for use. ④

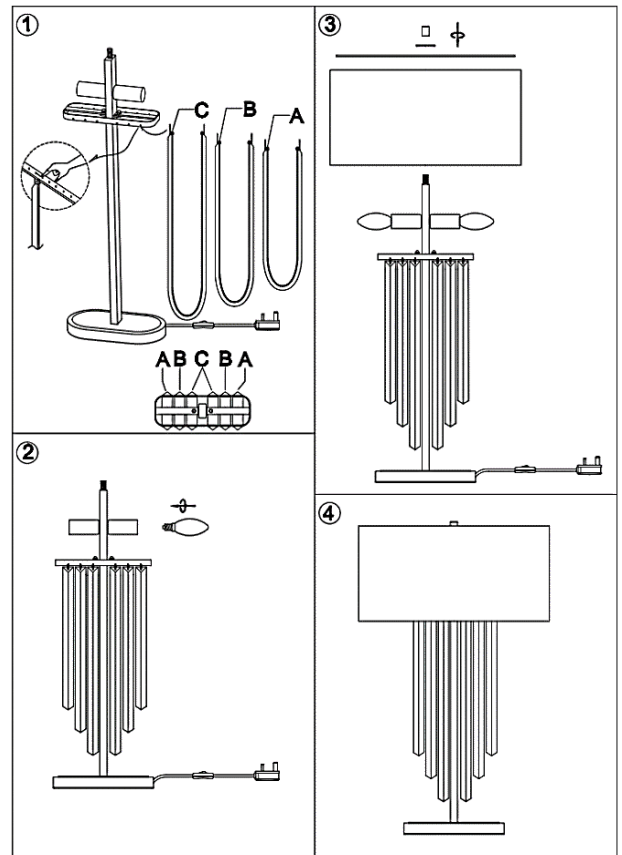

### GENERAL INFORMATION

This product is designed for internal use only. **Do not use polish or abrasive cleaner – just a soft dry cloth.**

Buying this product helps keeps the story of England alive for future generations.  
Thank you for your support.

© English Heritage

The English Heritage Trust is a charity, no. 1140351, and company, no. 07447221, registered in England.

Manufactured under licence by

UK: dār Lighting Ltd, Wildmere Road, Banbury, Oxon, OX16 3JZ

IRELAND & EU: dār Lighting Ireland Limited, Suite 108, Q House, 76 Furze Road, Sandyford Industrial Estate, Dublin.